

# 100mA Split Core Current Transformer

Split core, 100mA output

Model: CTSA Series

## Characteristics:

### Technical Index:

Hanging installation,

Material of Core: silicon steel sheet

Work Voltage:  $\leq 660\text{Vac}$

Operation Temperature:  $-15^{\circ}\text{C}\sim+50^{\circ}\text{C}$

Work Frequency: 50HZ~1KHZ



## Specification:

Rated Input (Effective Value)	50A	100A	150A	200A	250A	300A	400A	600A
Accuracy Class	0.5	0.5	0.5	0.5	0.5	0.5	0.5	0.5
Inner Diameter	24	16	24	24	35	35	35	35
Measurement Range	20~120%							
Rated Output	100mA							
Frequency	50~60Hz							
Weight	300g	120g	300g	350g	350g	410g	450g	500g

## Outline Size(in:mm):

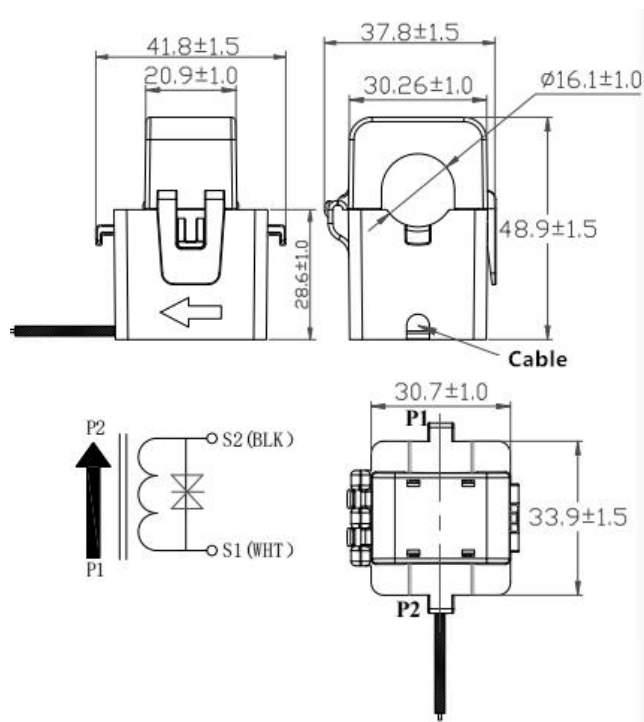

Inner Diameter 16mm

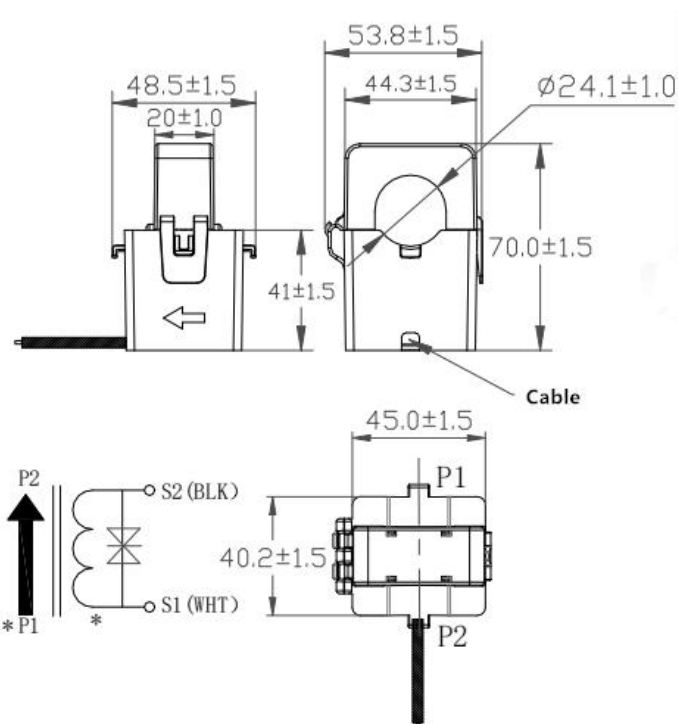

Inner Diameter 24mm



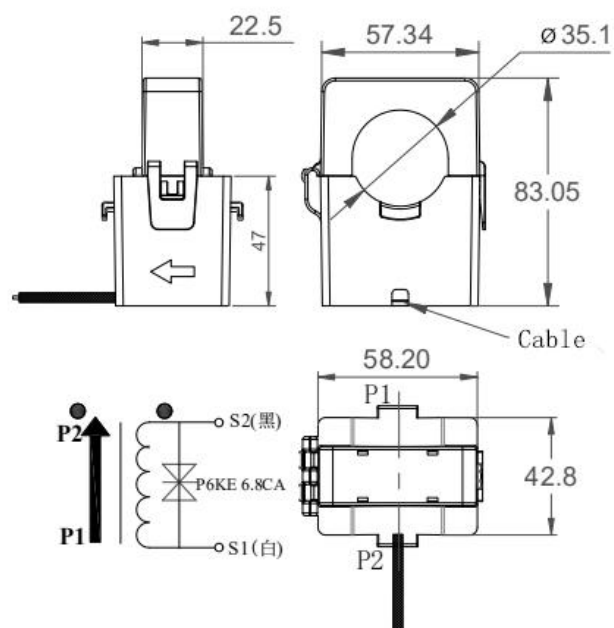

Inner Diameter 35mm

## Installation Diagram

Primary coil through hole method

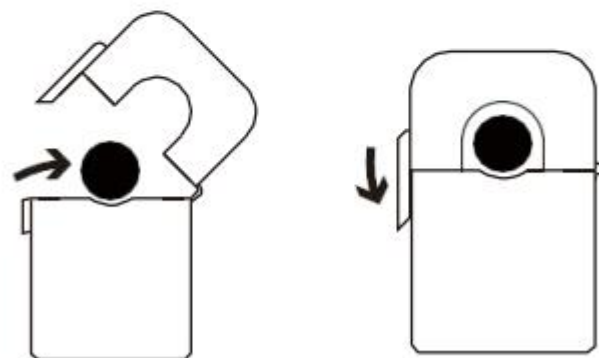
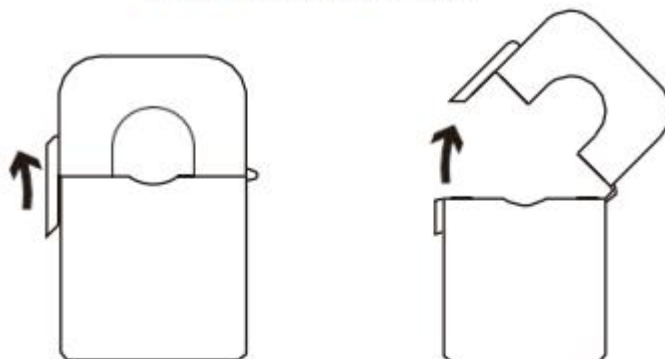

3.put the primary coil in the hole 4.close the clamp